

1 Demolition Plan
Scale: 1:100

GENERAL DEMOLITION NOTES:

1. READ THIS DRAWING IN CONJUNCTION WITH CONSTRUCTION DOCUMENTS. COORDINATE WITH OTHER TRADES TO ESTABLISH EXACT EXTENT OF DEMOLITION REQUIRED.
2. ALL WORK IN THIS CONTRACT TO COMPLY WITH AUTHORITIES HAVING JURISDICTION. OBTAIN ALL NECESSARY PERMITS AND APPROVALS FROM GOVERNING AUTHORITIES.
3. ALL DEMOLITION WORK TO BE CARRIED OUT AS PER LANDLORD'S REGULATIONS AND WORK PROCEDURES. COORDINATE WITH LANDLORD FOR REMOVAL OF DEBRIS AND REFUSE. ALL DISPOSAL SHALL BE MADE BY LEGAL MEANS.
4. ROLL UP EXISTING WINDOW TREATMENTS AND PROTECT FROM DUST AND DAMAGE DURING THE COURSE OF DEMOLITION IF REQUIRED.
5. PROTECT ALL AREAS TO REMAIN FROM DAMAGE AS REQUIRED. REPAIR AND MAKE GOOD TO RECEIVE NEW FINISHES AS SPECIFIED.
6. DO NOT DAMAGE EXISTING FIRE PROTECTIONS AND FIRE SEPARATION ASSEMBLIES. REPAIR ANY DAMAGES INCURRED BY THIS CONTRACT IMMEDIATELY TO RESTORE THE ORIGINAL FIRE PROTECTION RATING AND SEPARATION RATING.
7. CAREFULLY REMOVE ALL DOORS, DOOR FRAMES, DOOR HARDWARE, SIDELIGHT FRAMES AND GLAZING. RETURN REMOVED ITEMS TO OWNER. RETURN HARDWARE IN BOXES.

MAIN ELECTRICAL DEMOLITION ITEMS

- WALL SCONCE TO BE REMOVED AND CAPPED OFF BY ELECTRICIAN
- ALL LAY IN CEILING LIGHTING TO BE REMOVED AND UPGRADED WITH LED LIGHTING.



PROJECT NORTH:



SITE LOCATION NORTH:



IF ANY INFORMATION IS UNCLEAR, PLEASE CONSULT DESIGNER / PROJECT MANAGER / SITE SUPERVISOR ASAP FOR CLARIFICATION.

This document is copyright and shall not be used, altered, shared or reproduced without written consent from truspace. Do not scale drawings. This document is confidential and may contain private information intended for use by authorized personnel only.
All sub-contractors shall verify all site dimensions, all drawings, details, and specifications, and report any discrepancies to the Interior Designer in writing before proceeding with any work.
© truspace (all rights reserved)

REVISIONS

ISSUE	DESCRIPTION	DATE
1	ISSUED FOR	DATE
2	ISSUED FOR	DATE

PRELIMINARY

ISSUE	DESCRIPTION	DATE
1	ISSUED FOR CLIENT REVIEW	DATE

CLIENT:
COPIESMART
MBA HOUSE, WESBROCK VILLAGE, UBC VANCOUVER, B.C

SCALE:
1:100 @ 11X17

DRAWN BY: JM
CHECKED BY: JM

DRAWING TITLE:
DEMOLITION PLAN

PROJECT #:
PR30301
DWG SHEET #:
ID.1.1

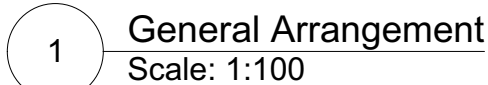

A PARTITION
RUNS FROM FLOOR TO 2200MM AFL

- 12MM GWB
- 92MM METAL STUDS
@406MM O.C.

B PARTITION
RUNS FROM FLOOR TO CEILING (3352MM)

- *(12MM) GWB
- 2 1/2" (92MM) METAL STUDS
@16" (406MM) O.C.
- BATT INSULATION
- 1/2" (12MM) GWB

- ### GENERAL PARTITION PLAN NOTES:
1. CONTRACTOR MUST OBTAIN ALL CONSTRUCTION PERMITS REQUIRED BY ALL RELEVANT AUTHORITIES BEFORE COMMENCING WORK. ONE SET OF PERMIT APPROVED DRAWINGS TO BE KEPT ON SITE AND AVAILABLE FOR CHECKING BY BUILDING INSPECTOR AT ALL TIMES DURING CONSTRUCTION.
 2. ALL WORK IS TO BE CARRIED OUT ACCORDING TO ALL RELEVANT CODES AND STANDARDS AND AS PER ANY SPECIFICATIONS ISSUED BY THE DESIGNER.
 3. PROVIDE SUPERVISION, LABOUR, MATERIALS, EQUIPMENT, APPLIANCES AND SERVICES AS NECESSARY OR REQUIRED FOR THE PROPER CONSTRUCTION AND COMPLETION OF THE WORK ON SCHEDULE AND FOR TEMPORARY SERVICES AND MAINTENANCE OF THE WORK SITE DURING CONSTRUCTION. PROVIDE ALL INSURANCE AND BONDING REQUIREMENTS
 4. ALL WORK SHALL BE DONE IN ACCORDANCE WITH THE OCCUPATIONAL HEALTH AND SAFETY ACT AND REGULATIONS FOR CONSTRUCTION PROJECTS.
 5. THIS DRAWING TO BE READ IN CONJUNCTION WITH MECHANICAL AND ELECTRICAL ENGINEERING DRAWINGS AND SPECIFICATIONS. REPORT ANY DISCREPANCIES BETWEEN CONSULTANTS DRAWINGS TO DESIGNER FOR CLARIFICATION.
 6. CONTRACTOR IS RESPONSIBLE TO INSPECT SITE PRIOR TO THE COMMENCEMENT OF CONSTRUCTION AND REPORT IMMEDIATELY TO THE CONSULTANT ANY UNACCEPTABLE CONDITIONS OR DISCREPANCIES FROM THE CONTRACT DOCUMENTS.
 7. ALL PARTITIONS ARE TO BE CHALKED ON SITE & APPROVED BY DESIGNER PRIOR TO INSTALLATION OF FLOOR & CEILING TRACK.
 8. ALL NEW PARTITIONS TO BE TAPED, SANDED, SMOOTH, PRIMED TIGHT TO FLOOR AND MADE READY TO RECEIVE FINISHES AS SPECIFIED. ALL DRYWALL PARTITION EDGES ARE TO BE SMOOTH AND PLUMB LINE TRUE.
 9. UNLESS OTHERWISE NOTED, ALL DIMENSIONS ARE TAKEN FROM FINISHED FACE OF WALL TO FINISHED FACE OF PARTITION. ALL DIMENSIONS TAKEN FROM THE CORE, COLUMNS OR CONVECTORS ARE TAKEN FROM THE FACE OF THAT ARCHITECTURAL ELEMENT TO THE FINISHED FACE OF THE PARTITION.
 10. CONTRACTOR TO ENSURE VARYING WALL THICKNESSES COORDINATE WITH DOOR FRAME SIZES. ANY DISCREPANCIES TO BE BROUGHT TO THE DESIGNER'S ATTENTION.
 11. CONTRACTOR TO ENSURE THE FLOOR IS LEVEL PRIOR TO THE CONSTRUCTION OF PARTITIONS. PROVIDE SKIM COAT IF NECESSARY. VARIANCE NOT TO EXCEED 1/4" IN 10'-0". AREAS WHERE FILING CABINETS OR SHELVING UNITS ARE TO BE LOCATED. REFER TO FURNITURE PLAN FOR CABINET LAYOUTS.
 12. CONTRACTOR TO REFER TO THE REFLECTED CEILING PLAN AND PARTITION TYPES FOR ALL WALLS THAT CONTINUE ABOVE SUSPENDED CEILING. CONTRACTOR TO REVIEW MECHANICAL DRAWINGS TO ENSURE PROVISION FOR AIR TRANSFER OPENINGS ABOVE CEILING PARTITION
 13. CONTRACTOR SHALL NOT USE MECHANICAL FASTENERS TO BASE BUILDING CEILING GRID, T-BAR, OR WINDOW MULLIONS (CADDY CLIPS ONLY)
 14. ALL MATERIALS USED SHALL BE NEW, UNLESS OTHERWISE NOTED.
 15. IN LOCATIONS WHERE BASE BUILDING WALLS OR COLUMNS ARE TO RECEIVE ELECTRICAL CONDUIT AND BOXES, DRYWALL CONTRACTOR IS RESPONSIBLE FOR FURRING, CUTTING, PATCHING, AND FINISHING AS PER SPECIFICATIONS AT COMPLETION OF ELECTRICAL WORK
 16. CONTRACTOR TO SUBMIT SHOP DRAWINGS TO DESIGNER FOR APPROVAL OF ALL MILL/WORK UNITS PRIOR TO FABRICATION. THE CONTRACTOR SHALL CHECK, SIGN AND MAKE ALL NOTATIONS HE CONSIDERS NECESSARY TO THE SHOP DRAWINGS BEFORE SUBMISSION TO THE CONSULTANT FOR REVIEW OR THEY WILL BE RETURNED UNCHECKED. THE CONSULTANT TAKES ABSOLUTELY NO RESPONSIBILITY FOR DELAYS OR SUBSEQUENT COSTS CAUSED BY THE CONTRACTOR'S FAILURE TO COMPLY WITH THIS PROVISION.
 17. UNLESS NOTED OTHERWISE, CARRY OVER SAME WALL CONSTRUCTION DETAILS AS DOORS AND SIDELITE
 18. PROVIDE 1" LETTERING "EMERGENCY EXIT UNLOCKED BY FIRE ALARM" SIGN PERMANENTLY MOUNTED ON DOORS EQUIPPED WITH MAGNETIC LOCKING DEVICES.



PROJECT #:	DWG SHEET #:
PR30301	ID.1.2

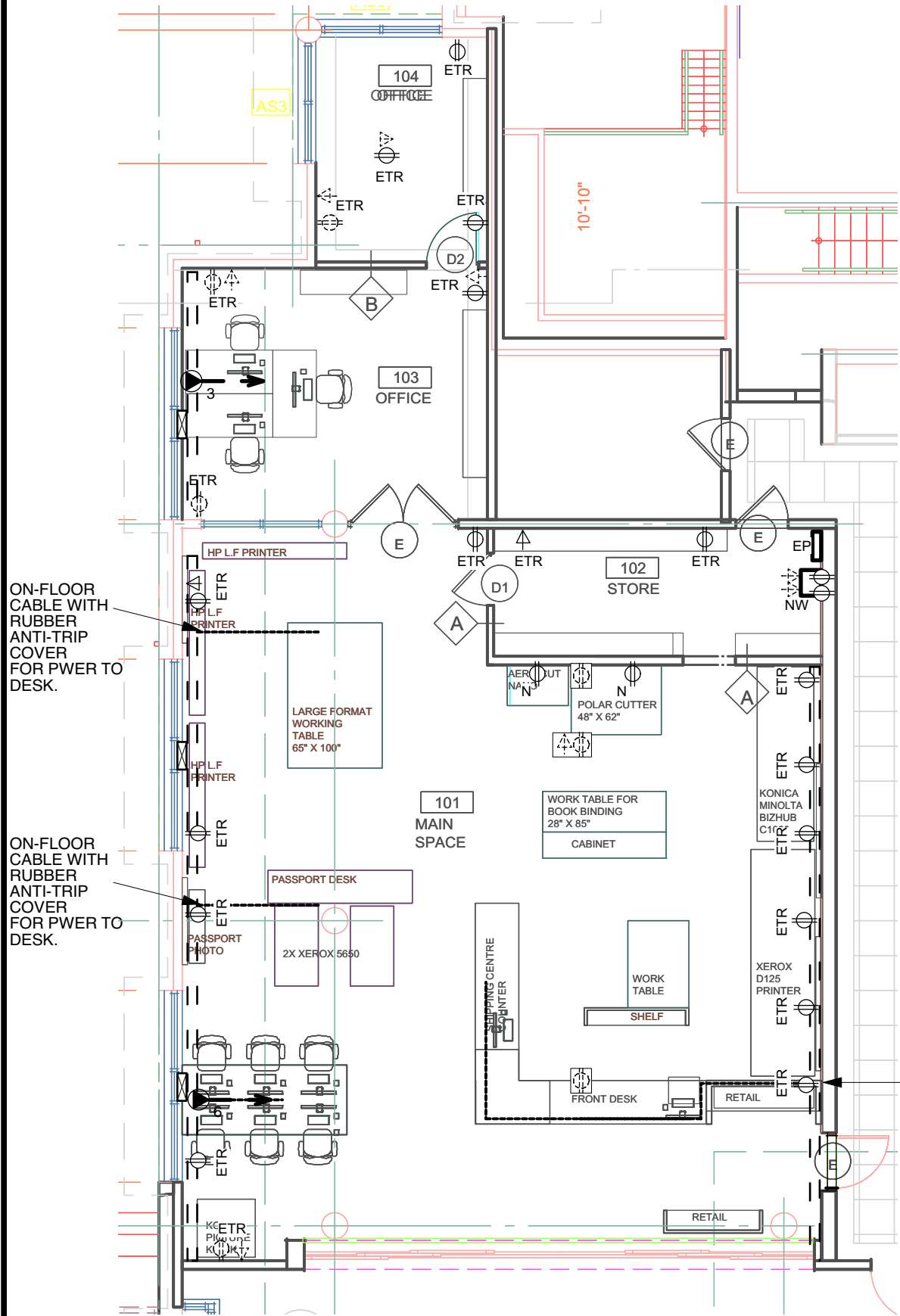

1 Electrical Layout
Scale: 1:100

POWER & COMMUNICATION LEGEND:
SYSTEMS FURNITURE

SYMBOL	DESCRIPTION
	WALL MOUNTED FEED FOR SYSTEMS FURNITURE OR WIRE MOLD FEED TO SUPPLY: X DATA X VOICE X DUPLEX N' NUMBER OF STATIONS AT EACH FEED LOCATION INDICATED ON PLAN.

POWER & COMMUNICATION LEGEND:
TYPICAL POWER WHIP INSTALLATION

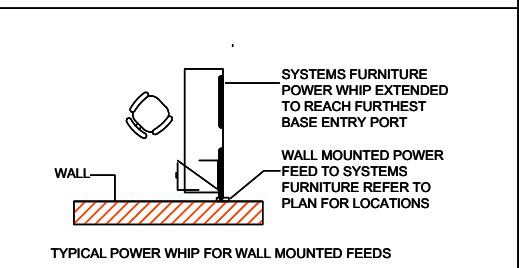

EP NEW ELECTRICAL PANEL.
ALL POWER FOR UNIT TO BE BROUGHT DOWN TO THIS NEW LOCATION BY LANDLORD / UBC. LANDLORD TO CONFIRM REQUIRED DIMENSIONS.

NW NETWORK PANEL, BY CLIENT. POWER / DATA REQUIREMENTN TBC BY CLIENT

DOTTED RECTANGLE INDICATES LEGRAND 4000 SERIES WIREMOLD TO PERMITER WALLS, INSTALLED AT 300MM AFL.
ELECTRICAL CONTRACTOR TO CONFIRM HOWE MUCH POWER CLIENT CAN ADD BASED ON CURRENT LOAD, SO THAT INSTALL IS FUTURE-PROOFED FOR THEIR NEEDS.

POWER FROM LHS WIREMOLD TO BE FED UP AND ACROSS CEILING VOID TO NEW PANEL LOCATION. FINAL DETAIL BY ELECTRICAL CONTRACTOR / ELECTRICAL CONSULTANT.

INTERNALLY ILLUMINATED SIGN MOUNTED OFF WINDOW SILL. POWER FROM SURFACE MOUNTED WIREMOLD.

GENERAL POWER & COMMUNICATION NOTES:

1. ALL ELECTRICAL AND COMMUNICATIONS WORK TO COMPLY WITH THE REQUIREMENTS OF THE BUILDING LANDLORD AND THOSE AUTHORITIES HAVING JURISDICTION.
2. POWER & COMMUNICATION DRAWING TO BE USED FOR LOCATIONS OF SERVICES ONLY. ALL OUTLET AND CORE DRILL LOCATIONS TO BE REVIEWED AND APPROVED ON SITE BY THE DESIGNER. REFER TO ELECTRICAL ENGINEERS' DRAWINGS FOR TECHNICAL, ELECTRICAL DETAILS, SPECIFICATIONS AND DATA REQUIREMENTS.
3. CONTRACTOR TO REPORT ANY DISCREPANCIES BETWEEN THE ENGINEERS' AND DESIGNER'S DRAWINGS TO THE DESIGNER AND THE ELECTRICAL ENGINEER PRIOR TO COMMENCING WORK.
4. SUBMIT ANY REQUIRED CHANGES TO THE DESIGNER FOR APPROVAL PRIOR TO PROCEEDING.
5. UNLESS OTHERWISE NOTED, ANY DIMENSIONS ARE TAKEN TO THE CENTER OF THE SERVICE OR GROUP OF SERVICES. ANY DIMENSION FROM A PARTITION IS TAKEN FROM FACE OF THAT PARTITION TO THE CENTER OF THE INDICATED SERVICE OR GROUP OF SERVICES.
6. REFER TO ENGINEER'S DRAWINGS FOR THE SPECIFICATION OF COVER PLATE AND RECEPTACLE TYPE AND COLOUR. REFER TO THE DESIGNER'S ELECTRICAL PLAN FOR MOUNTING HEIGHTS.
7. WHERE POWER & COMMUNICATION SERVICES ARE ADJACENT ON PLAN, GANGED COVER PLATES SHALL BE USED.
8. CONTRACTOR IS TO ENSURE THAT ALL TRADES, ELECTRICAL, MECHANICAL, COMMUNICATIONS, ETC. HAVE COMPLETED THEIR PORTION OF THE WORK BEFORE BOARDING UP BOTH SIDES OF THE STUDS. THIS IS TO INCLUDE ALL INSPECTIONS AS REQUIRED BY LOCAL AND PROVINCIAL BY-LAWS AND BUILDING CODES.
9. SOUND BATTS IN PARTITIONS ARE TO CONTINUE BEHIND ALL POWER AND TELEPHONE OUTLETS WITHOUT INTERRUPTION.
10. STAGGER OUTLETS ON OPPOSITE SIDES OF THE SAME PARTITION TO MAINTAIN THE ACOUSTICAL INTEGRITY.
11. ANY FURNITURE SYSTEM WHIPS REQUIRED TO BE SUPPLIED BY OTHERS, ELECTRICAL CONNECTION OF SYSTEMS FURNITURE BY ELECTRICAL CONTRACTOR.
12. INSTALL NEW BLANK COVER PLATES ON ALL UNUSED OUTLETS. FINISH OF COVER PLATES TO MATCH EXISTING.

EDMONTON • CALGARY • VANCOUVER • TORONTO

PROJECT NORTH:

SITE LOCATION NORTH:

IF ANY INFORMATION IS UNCLEAR, PLEASE CONSULT DESIGNER / PROJECT MANAGER / SITE SUPERVISOR ASAP FOR CLARIFICATION.

This document is copyright and shall not be used, altered, shared or reproduced without written consent from truspace. Do not scale drawings. This document is confidential and may contain private information intended for use by authorized personnel only.
All sub-contractors shall verify all site dimensions, all drawings, details, and specifications, and report any discrepancies to the Interior Designer in writing before proceeding with any work.
© truspace (all rights reserved)

ISSUE	DESCRIPTION	DATE
	ISSUED FOR	DATE
	ISSUED FOR	DATE

CLIENT:
COPIESMART

MBA HOUSE, WESBROCK VILLAGE, UBC VANCOUVER, B.C

SCALE:
1:100 @ 11X17

DRAWN BY: JM
CHECKED BY: JM

DRAWING TITLE:
ELECTRICAL PLAN

PROJECT #:
PR30301

DWG SHEET #:
ID.1.3

PRELIMINARY



LANDLORD TO CONFIRM
REQUIREMENTS FOR REPLACING EXIT
SIGNAGE WITH NEW GREEN RUNNING
MAN SIGNAGE.

All exhaust air to go through louvres on external of the building and be at least 5-10 feet apart. TBC with engineer.

EXISTING CEILING BAFFLE
FIXTURE TO REMAIN

Reflected Ceiling Plan
Scale: 1:100